

OREGON PUBLIC LAND CORNER REPORT / RESTORATION REPORT
Tillamook County Surveyor's Office

BOOK 8 199

SECTION: 6 and 7	TOWNSHIP: 3 South	RANGE: 10 West
COUNTY: Tillamook		DATE: 11/1/2023
CORNER DESIGNATION: The Quarter corner common to sections 6 & 7, Township 3 South, Range 10 West, Willamette Meridian, Tillamook County, Oregon.		(Please check one)
		<input type="checkbox"/> Condition Report Only
		<input type="checkbox"/> Restoration
		<input checked="" type="checkbox"/> Rewitness
		<input type="checkbox"/> Unrecorded
		<input type="checkbox"/> Reset at surface
		<input type="checkbox"/> Referenced Out

Previous Rewitnesses, Restorations and Surveys, etc... Original G.L.O. field notebook 3S 10W pg. 62 (1890), Rewitness Bk. 3 pg. 206 and 207 (1933), Rewitness Bk. 3 pg. 19A (±1951), Rewitness Bk. 4 pg. 86 (1951), Rewitness Bk. 1 pg. 94 (1951), B-292 (1951), Rewitness Bk. 3 pg. 319 (1969), F-27-25 (1972), Rewitness Card #578 (1979), B-1458 (1990)

History, condition, and sources: In 1890 (G.L.O. 3S10 pg. 62) under G.L.O. contract number 552 Albert P. Wilson set a 4"x 4" post for corner and established two bearing trees. In 1933 (Rewitness Bk. 3 pg. 206 and 207) Ernest P. Rands district cadastral engineer set a 1" diameter iron post with a Brass Cap for corner using original bearing trees for reference. In 1969 (Rewitness Bk. 3 pg. 319) Tom O. McCullough set a steel post with a Forest Service boundary sign facing south, a steel post 5' north facing to the west and established one new bearing tree. He found a 25" Hemlock stump with two Forest Service tags and a downed 30" Spruce with Forest Service tag visible. In 1979 (Rewitness Card #578) Tillamook County Surveyor's Office set a 10" tile with concrete around the found Brass Cap and established one new bearing tree. In 1990 (B-1458) Ronald H. Schulson set an orange fiber glass post alongside the corner. In 2023 Tillamook County Surveyor's Office visited the corner and found a 2 1/2" U.S. General Land Office Brass Cap marked "1/4 S6 S7 1933" in concrete and tile in good condition as shown hereon.

Found: (G.L.O. 3S10 pg. 62) Spruce down N.29° E. 18.48' (40" Spruce uprooted N.26° E. 18.48').

Found: (G.L.O. 3S10 pg. 62) Rotted Stump (36" Stump S.73° E. 19.14').

Found: (Rewitness Bk. 3 pg. 319) 32" Spruce N.49° W. to center (10" Spruce N.41° W. 15.9').

Found: (Rewitness Card #578) 31" Spruce N. 09° W. 14.4' (12" Spruce S.10° W. 15.6' Bearing Tree Tag reads N. 5° E. 15.9").

Found: (Rewitness Bk. 3 pg. 319) Broken off metal post stub in ground S.66° W. 1.4' (SLY 1.0').

Found: (Rewitness Bk. 3 pg. 319) Broken off post on ground and stub in ground N. 20° W. (NLY 5.0').

Found: (B-1458) Carsonite post S.75° W. 1.7'.

New accessories set:

Set: Hat Section Post with yellow metal location tag North 2.6'

Pictures of Found Monuments:



Location: This corner is located ± 2 miles Northwest on Cape Lookout Road from Sandlake road junction. ± 500' Westerly from Cape Lookout Road. ± 30' Southerly of an old partially grown over logging road, in a swampy area.

Tillamook County Surveyor office: 1510 3rd Street Suite C, Tillamook, OR. 97141

Party Chief: Travis Porter, Tillamook County Survey Office

Witnesses: Michael Rice, PLS 86926, Tillamook County Surveyor
Kael Poklikuha, Tillamook County Survey Technician

Notes: Digital images taken of monument and accessories.



SURVEYOR'S SEAL

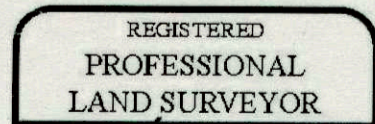

Michael R. Rice

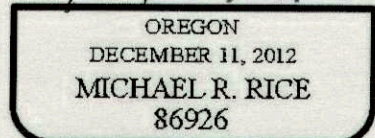

RENEWAL 12-31-2024

BOOK 8 199